

Ignition system - exploded view

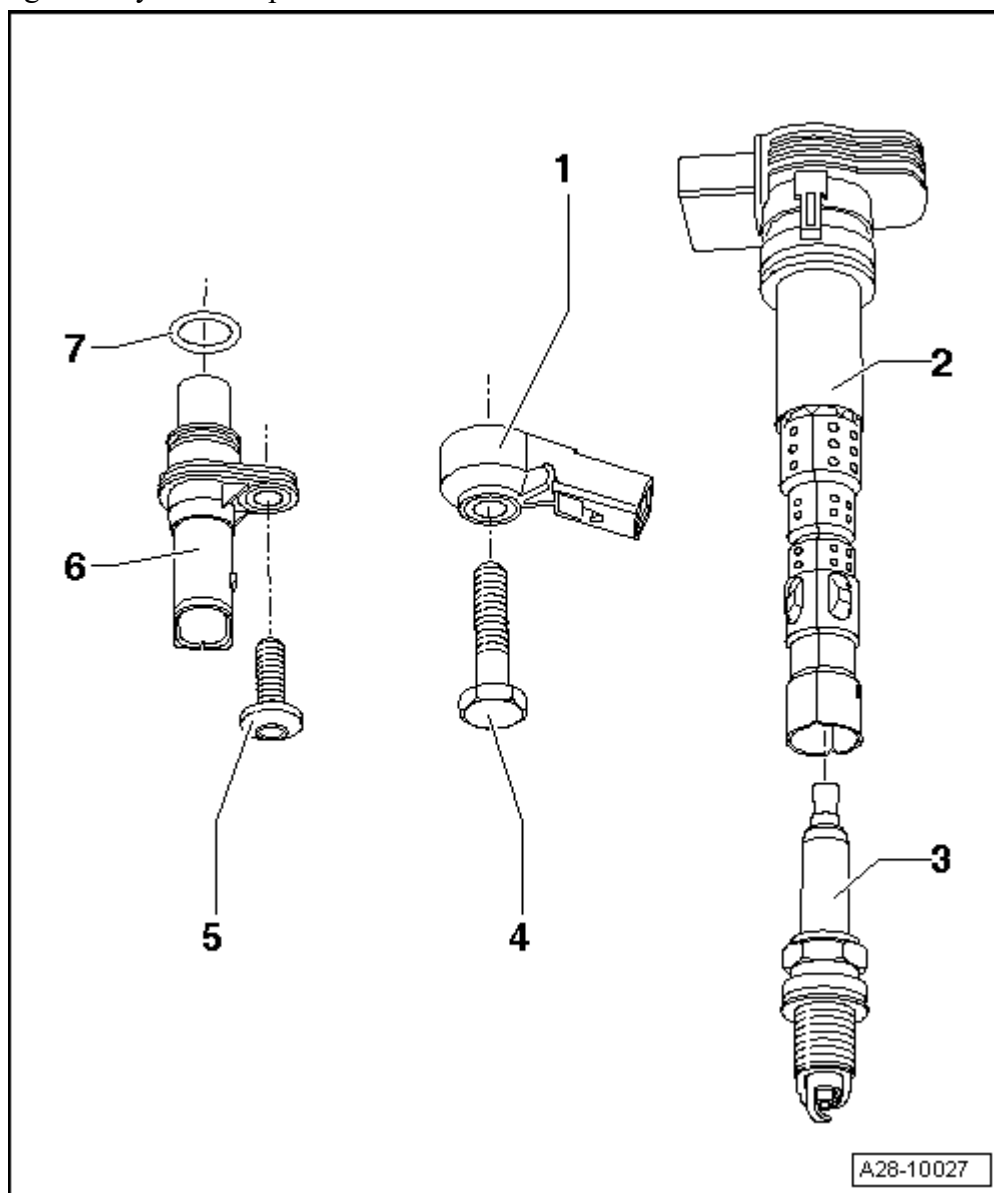

1 - Knock sensor

q Knock sensor 1 -G61-

q Knock sensor 2 -G66-

q Knock sensor 3 -G198-

q Knock sensor 4 -G199-

q Contacts gold-plated

q Removing and installing → [Chapter](#)

2 - Ignition coil with output stage

q Ignition coil 1 with output stage -N70-

q Ignition coil 2 with output stage -N127-

q Ignition coil 3 with output stage -N291-

q Ignition coil 4 with output stage -N292-

q Ignition coil 5 with output stage -N323-

- q Ignition coil 6 with output stage -N324-
- q Ignition coil 7 with output stage -N325-
- q Ignition coil 8 with output stage -N326-
- q Removing and installing → [Chapter](#)
- q Use puller -T40039- for removal
- 3 - Spark plug
- q 30 Nm
- q For removing and installing refer to →
- 4 - Bolt
- q 20 Nm
- q Tightening torque influences the function of the knock sensors
- 5 - Bolt
- q 10 Nm
- 6 - Hall sender -G40-
- q Hall sender 2 -G163-
- q Hall sender 3 -G300-
- q Hall sender 4 -G301-
- q Contacts gold-plated
- 7 - O-ring
- q Renew O-Ring if damaged